

POLE BRACING DETAIL

12' 6" 0" 1' 2' SCALE -- 1/2" = 1'-0"

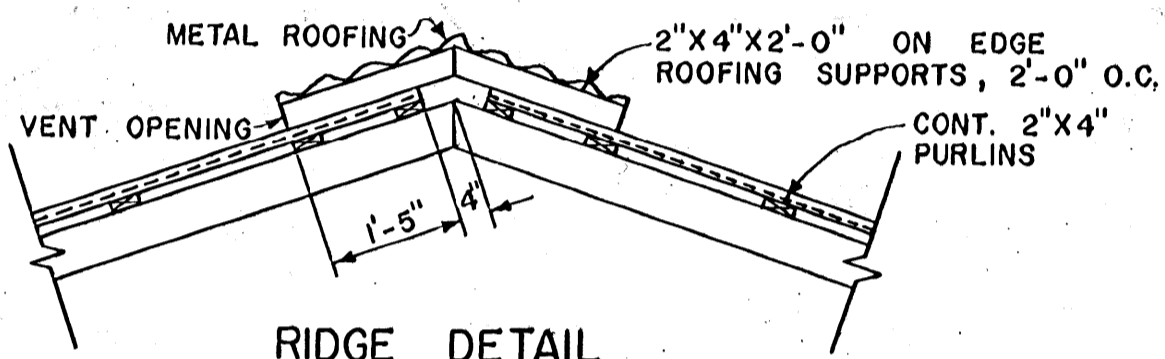

RIDGE DETAIL

12' 6" 0" 1' 2' SCALE -- 1/2" = 1'-0"

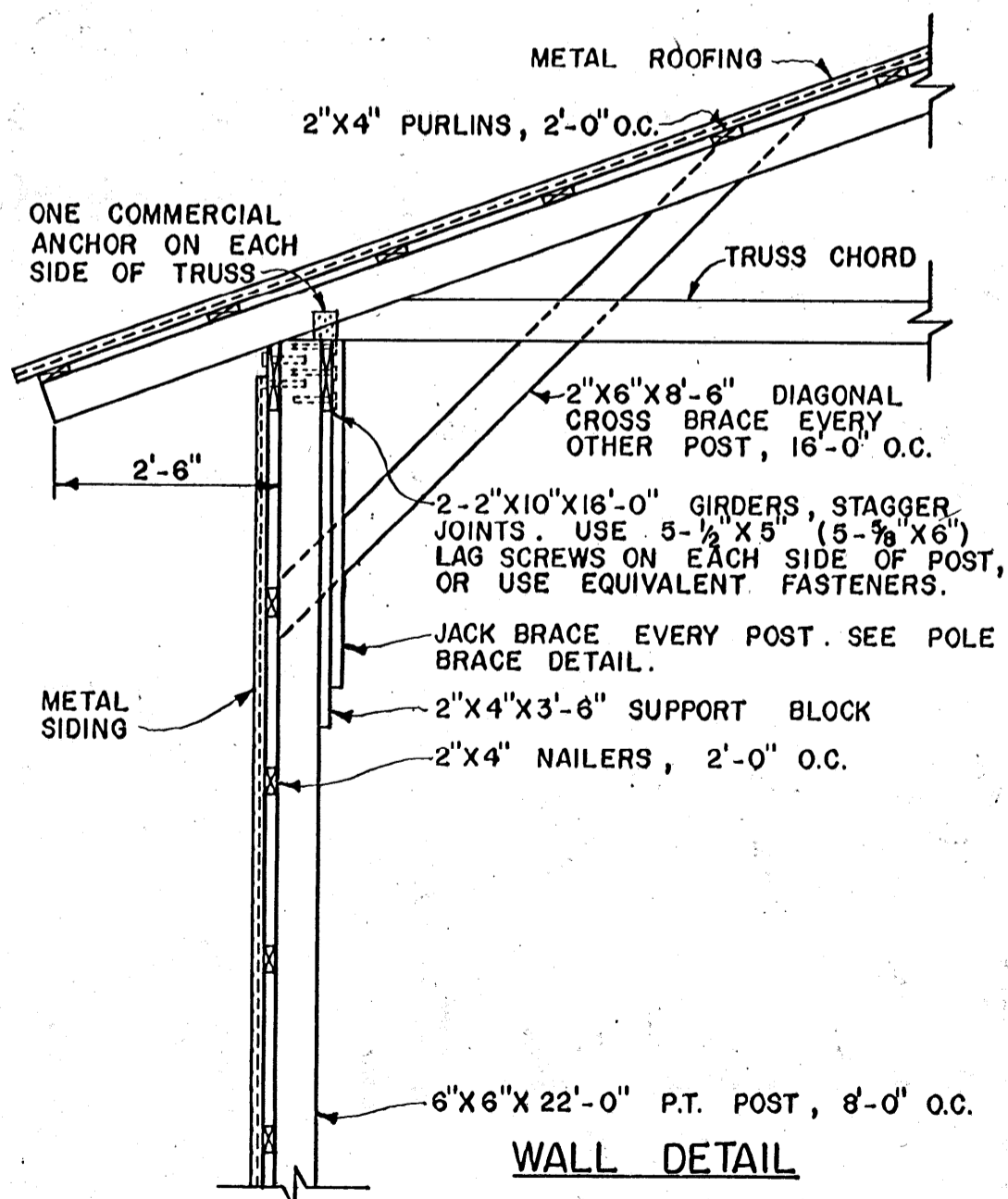

WALL DETAIL

12' 6" 0" 1' 2' SCALE 1/2" = 1'-0"

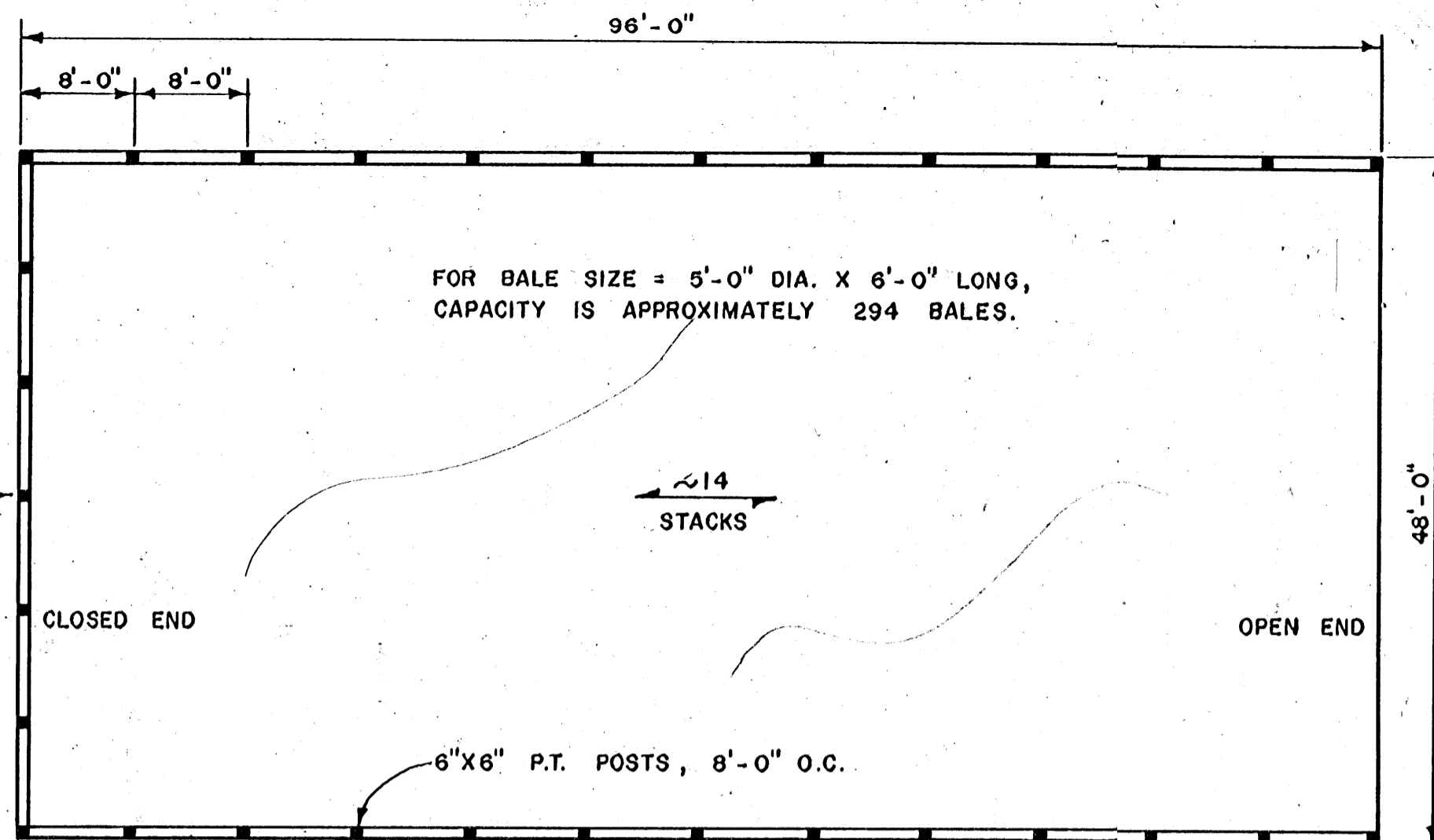

PLAN

12' 0' 3' 8' 15' SCALE -- 3/32" = 1'-0"

NOTES:

1. P.T. = PRESSURE TREATED. TREAT TO A PRESERVATION RETENSION OF 5-7 POUNDS PER CUBIC FOOT AS PER A.W.P.A. STANDARDS.
2. BALES WILL SETTLE AND SPREAD. ALLOW 4'-5" ON ALL SIDES OF EACH BALE WHEN PLANNING STORAGE.
3. SELECT TRUSS THAT SUPPORTS SNOW AND WIND LOADS FOR YOUR AREA. SPACE TRUSSES 4' O.C. (2' O.C.) DESIGN SHOWN IS FOR A 20 LBS. PER SQ. FT. SNOW LOAD. FIGURES IN () INDICATE REQUIREMENTS FOR A 30 LBS. PER SQ. FT. SNOW LOAD.

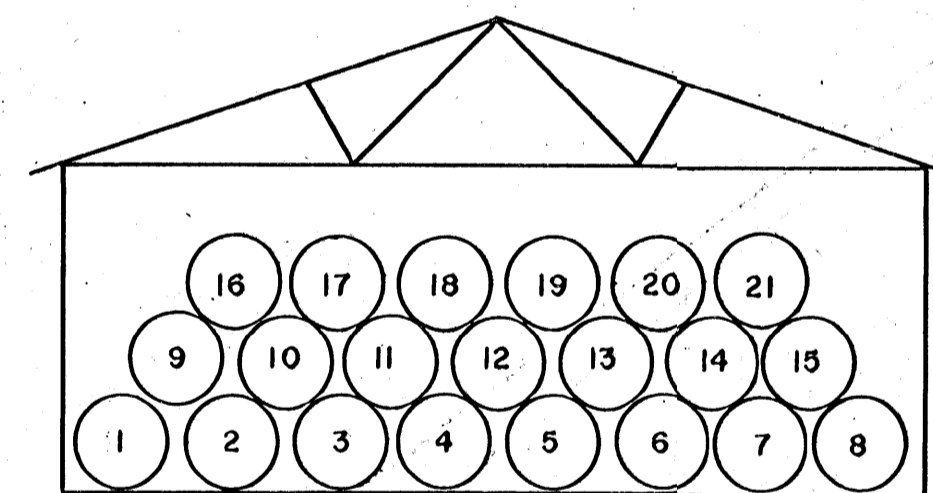

STACKING DIAGRAM
(21 BALES, 5' DIAMETER)

12' 0' 3' 8' 15' SCALE -- 3/32" = 1'-0"

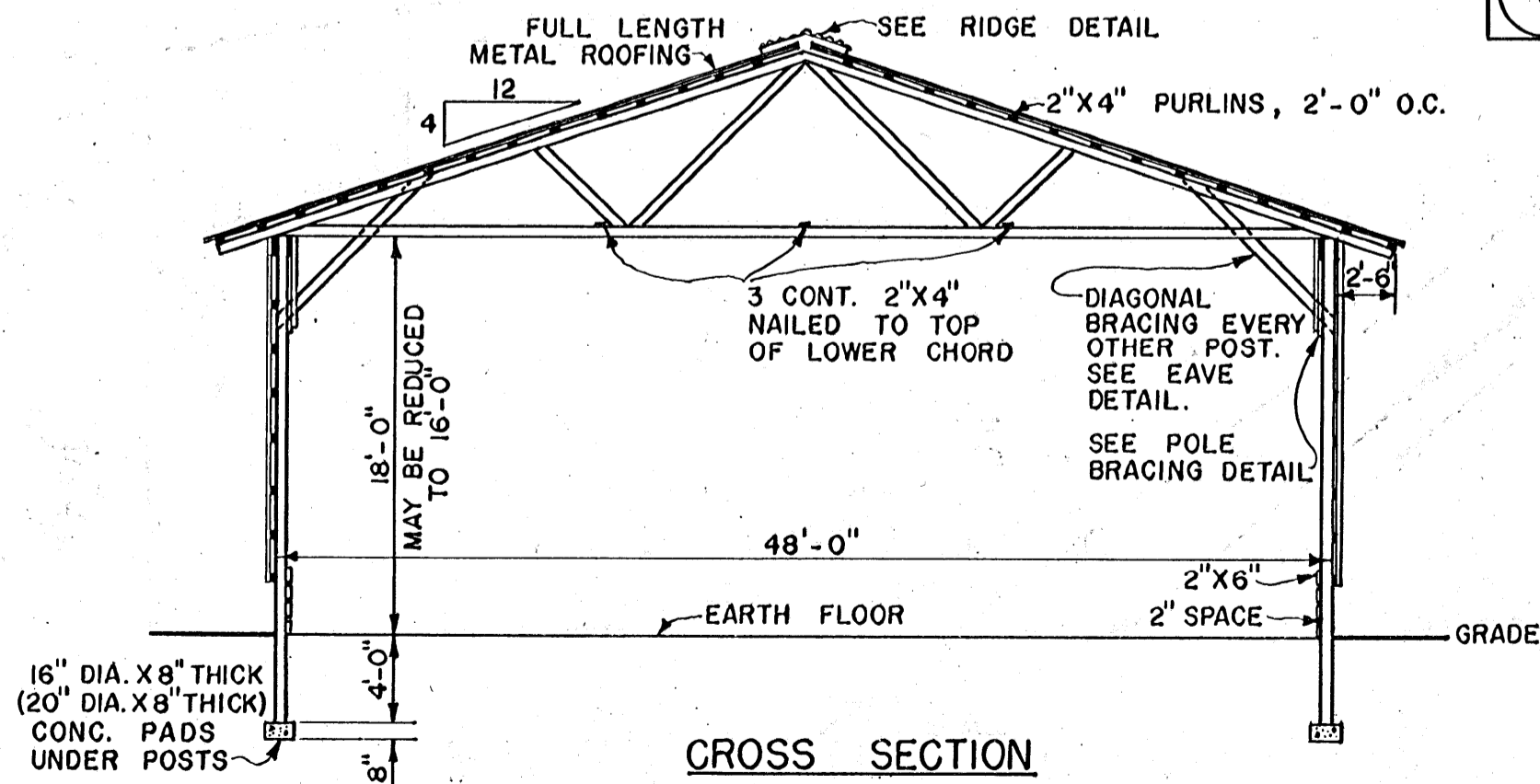

CROSS SECTION

0' 1" 4" 8" 12" SCALE -- 1/8" = 1"

COOPERATIVE EXTENSION WORK IN
AGRICULTURE AND HOME ECONOMICS
STATE OF MISSISSIPPI
MISSISSIPPI STATE UNIVERSITY
AND
UNITED STATES DEPARTMENT OF AGRICULTURE COOPERATING

HAY STORAGE FOR LARGE ROUND BALES

TN '80 EX. 6350 SHEET 1 OF 1